

# EN1223S/EN1223S-60 EchoStream® Single-Button Water-Resistant Pendant Transmitter Installation and Operation Manual

## 1 Overview

The Inovonics single-button water-resistant pendant transmitter is our smallest, lightest, and most versatile pendant.

**Note:** For UL 2560 installations, refer to the *EN6080 Area Control Gateway Installation Instructions*.

### 1.1 Inovonics Wireless Contact Information

If you have any problems with this procedure, contact Inovonics Wireless technical services:

- E-mail: support@inovonics.com
- Phone: 1.800.782.2709, option 2

### 1.2 Maximum Number of Repeaters for a UL 2560 Installation

To achieve the 99.99% alarm message reliability required for UL 2560 compliance, system installations must operate within the following limits for end device and repeater counts.

End Devices	Maximum Repeaters
150	397
250	386
350	375
500	360
1000	313
2000	238
3000	184

### 1.3 Transmitter External Components

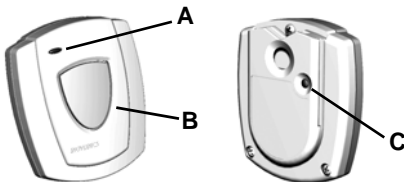

Figure 1 Transmitter external components

A Transmit LED    B Activation button    C Reset button

### 1.4 Transmitter Internal Components

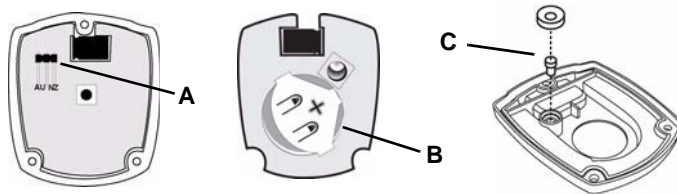

Figure 2 Transmitter internal components

A Frequency band selection pins    B Battery    C Reset button plunger assembly

### 1.5 What's In The Carton

Individually-packaged products include the following items:

- One EchoStream single-button water-resistant pendant transmitter
- One breakaway neck cord
- One beltclip attachment
- Three housing screws
- One frequency band selection jumper
- One CR2450 coin cell battery

**Note:** Bulk-packaged products are shipped with multiples of the above items, with the exception of batteries.

## 2 Installation and Startup

### 2.1 Installation Notes

- These products are designed to be maintained by professional security technicians
- Products are intended for indoor use
- All products should be manually tested weekly (see "Test the Transmitter" on page 2)

### 2.2 Battery Installation

1. Remove the rear housing cover to expose the side of the board that holds the battery.

**Caution:** Carefully separate the rear housing cover, ensuring the reset button plunger assembly does not fall out of the housing (Figure 2).

2. Slide the battery under the battery holder, ensuring that it is fully inserted and that the positive terminal (+) faces up (Figure 2).

### 2.3 Select the Frequency Band

EchoStream products are able to use a range of radio frequencies, and must be configured for your geographic area. This product ships with a default frequency range of 902-928 MHz for use in North America. If you are using the product in North America, skip to step 6; if you are using the product in Australia or New Zealand, you will need to configure the transmitter.

To configure the transmitter:

3. Turn the board over to access the side with the frequency band selection pins (Figure 2).
4. Place the frequency band selection jumper on the appropriate frequency band selection pins.
  - Place the jumper on the left two pins, marked AU, to set the frequency range to 915-928 MHz for Australia.
  - Place the jumper on the right two pins, marked NZ, to set the frequency range to 921-928 MHz for New Zealand.
5. Seat the board in the housing with the battery side facing the rear housing cover.
6. Replace the front housing cover.
7. Insert the three housing screws, tightening them to 1.25 inch-pounds torque.

**Note:** If you do not have a torque driver, tighten to a snug fit, being careful not to overtighten.

**Note:** Tighten the housing screws evenly to help ensure a good seal and maintain water-resistance.

**Caution:** Over-tightening the housing screws can result in microcracks in the plastic, gaps in the gasket material, and/or stripping of the bushing. Any of these conditions can compromise the water-resistance of the device.

### 2.4 Register the Transmitter

The transmitter must be registered and supervised. When supervised, the transmitter will send check-in message to the receiver or gateway as follows:

- EN1223S: every three minutes.
- EN1223S-60: every 60 minutes.

**Note:** In UL 2560 installations, transmitters send a check-in message every 60 minutes.

Each transmitter has a unique factory-programmed identification number. Refer to the receiver or gateway's installation instructions for details on registering and setting up supervision.

8. When prompted by the receiver or gateway to reset transmitter, press the reset button (Figure 1).

**Caution:** The transmitter should be tested after registration to ensure operation. See "Test the Transmitter" on page 2.

## 3 Operate the Transmitter

To send an alarm, press the activation button for at least one second. Alarm signals are transmitted multiple times and are indicated by the blinking transmission LED. When the button is released, the transmitter sends an alarm restoral signal as indicated by another short series of blinking transmission LED lights.

### 3.1 Wear the Transmitter

The pendant transmitter can be worn in three ways:

- Around the neck with neck chain attachment (included)
- On a belt with the beltclip attachment (included)
- On the arm with optional wristband accessory (ACC623S or ACC623L, sold separately)

**Caution:** The neck chain included with the pendant transmitter is designed with a breakaway feature for user safety. Substitution of a stronger cord or chain may result in injury to the wearer.

## 3.2 Water Exposure

UL has evaluated the single-button pendant transmitter to meet the water spray test required under UL 2560, section 38.1. Because the single-button pendant transmitter was not designed for submersion in water, it was not subjected to submersion tests under that standard.

All EchoStream water-resistant pendants also meet IP54 certification standards for dust and water ingress protection, ensuring that:

- Ingress of dust particles does not interfere with the satisfactory operation of the device
- There is no harmful effect to the device caused by:
  - Vertically dripping water (when device is tilted up to 15° from normal position)
  - Spraying water (falling at angles up to 60° from vertical)
  - Splashing water (from any direction)

**Note:** IP54 certification was performed by an independent laboratory not affiliated with UL.

## End User Recommendations

The pendant transmitter is water-resistant, but not waterproof. The product is not designed for submersion in water. As such, we offer the following recommendations to the end user:

Usage Situation	OK to Use?	Cautions
Shower	Yes	Do not spray water directly on the device at distances of less than 12 inches; avoid spraying water at high pressure
Bath	Yes	Do not submerge the device
Rain	Yes	Avoid extended exposure; wear the device under a sleeve, shirt, or jacket
Water Exercise	No	Do not use the device during these activities

## 3.3 Battery Replacement

Replacement batteries can be purchased from Inovonics using the following part numbers

- BAT609 for a single battery
- BAT609-25 for a 25-count bulk pack

To replace the batteries:

1. Remove the three housing screws on the back of the transmitter.
2. Remove the rear cover to expose the side of the board which holds the battery.

**Caution:** Carefully separate the rear housing cover, ensuring the reset button plunger assembly does not fall out of the housing (Figure 2).

3. Remove the depleted battery.
4. Slide the new battery under the battery holder, ensuring that it is fully inserted and that the positive terminal (+) faces up (Figure 2).
5. Replace the rear housing cover.
6. Replace the three housing screws, tightening them to 1.25 inch-pounds torque.
7. Once the unit has been sealed, press the reset button located on the rear housing to complete the configuration (Figure 1).

**Note:** If you do not have a torque driver, tighten to a snug fit, being careful not to strip the housing.

**Note:** Tighten the housing screws evenly to help ensure a good seal and maintain water-resistance.

**Caution:** Over-tightening the housing screws can result in microcracks in the plastic, gaps in the gasket material, and/or stripping of the bushing. Any of these conditions can compromise the water-resistance of the device.

## 4 Test the Transmitter

The transmitter should be tested weekly and after registration to ensure operation.

To test the transmitter:

1. Press the activation button for at least one second and ensure the transmit LED lights and the alarm is received by the receiver or gateway.
2. Press the reset button and ensure the transmit LED lights.

## 5 Specifications

Dimensions: 5.6 x 4.8 x 1.8 cm (2.2 x 1.9 0.72")

Operating temperature: 0 to 60°C (32 to 140°F)

Operating environment: Water-resistant, non-submersible

Typical battery life: 1-2 years

Battery type: Panasonic CR2450

Power requirement: 3 VDC, 60 mA

UL certification for EN1223S-60: UL 2560 (see conditions below)

**Note:** For UL 2560 installations, Inovonics repeaters must have 20 minute check-in times. Inovonics transmitters must have a minimum of 60 minute check-in times.

**Note:** In a UL 2560 installation, the EN1223S-60 single-button water-resistant pendant transmitter may be used with completed emergency call systems for assisted living and independent living facilities

For UL 2560 certified system installations, the following Inovonics EchoStream devices are approved for installation within maximum system configuration limits defined in section 1.2 of this document:

- EN6080 area control gateway
- EN5040-20T high power repeater
- End devices (transmitters) with a minimum 60-minute check-in interval, as follows:
  - Fundamental devices which are subject to UL2560 certification (pendant transmitters and OEM products using the Inovonics RF module)
  - Supplemental devices which are not subject to UL2560 system certification but which may be used within a UL2560 certified system (e.g. universal transmitters and activity sensors)

**Note:** Users that have achieved certification and will install UL 2560 certified systems are responsible for labeling all fundamental devices with the UL 2560 system certification mark.

Compatible receiver for UL 2560 installations with the EN1223S-60: EN6080

Compatible repeater for UL 2560 installations with the EN1223S-60: EN5040-20T

**Note:** Specifications and data are subject to change without notice.

## 6 Television and Radio Interference

This equipment has been tested and found to comply with the limits for a Class B digital device, pursuant to Part 15 of the FCC Rules. These limits are designed to provide reasonable protection against harmful interference in a residential installation. This equipment generates, uses and can radiate radio frequency energy and, if not installed and used in accordance with the instructions, may cause harmful interference to radio communications. However, there is no guarantee that interference will not occur in a particular installation. If this equipment does cause harmful interference to radio or television reception, which can be determined by turning the equipment off and on, the user is encouraged to try to correct the interference by one or more of the following measures:

- Reorient or relocate the receiving antenna.
- Increase the separation between the equipment and receiver.
- Connect the equipment into an outlet on a circuit different from that to which the receiver is connected.
- Consult the dealer or an experienced radio/TV technician for help.

## 7 FCC Part 15 and Industry Canada Compliance

This device complies with part 15 of the FCC Rules and Industry Canada license-exempt RSS standard(s). Operation is subject to the following two conditions: (1) this device may not cause interference, and (2) this device must accept any interference, including interference that may cause undesired operation of the device. Changes or modifications not expressly approved by the party responsible for compliance could void the user's authority to operate the equipment.

Le présent appareil est conforme aux CNR d'Industrie Canada applicables aux appareils radio exempts de licence. L'exploitation est autorisée aux deux conditions suivantes : (1) l'appareil ne doit pas produire de brouillage, et (2) l'utilisateur de l'appareil doit accepter tout brouillage radioélectrique subi, même si le brouillage est susceptible d'en compromettre le fonctionnement.

## 8 US Patent Numbers

- 7,154,866
- 7,554,932
- 7,746,804

## 9 Warranty and Disclaimer

Inovonics Wireless Corporation ("Inovonics") warrants its products ("Product" or "Products") to conform to its own specifications and to be free of defects in materials and workmanship under normal use for a period of thirty-six (36) months from the date of manufacture. Within the warranty period, Inovonics will repair or replace, at its option, all or any part of the warranted Product. Inovonics will not be responsible for dismantling and/or reinstallation charges. To exercise the warranty, the User ("User", "Installer" or "Consumer") must work directly through their authorized distributor who will be given a Return Material Authorization ("RMA") number by Inovonics. Details of shipment will be arranged directly through the authorized distributor.

This warranty is void in cases of improper installation, misuse, failure to follow installation and operating instructions, alteration, accident or tampering, and repair by anyone other than Inovonics.

This warranty is exclusive and expressly in lieu of all other warranties, obligations or liabilities, whether written, oral, express, or implied. There is no warranty by Inovonics that Inovonics product will be merchantable or fit for any particular purpose, nor is there any other warranty, expressed or implied, except as such is expressly set forth herein. In no event shall Inovonics be liable for an incidental, consequential, indirect, special, or exemplary damages, including but not limited to loss of profit, revenue, or contract, loss of use, cost of down time, or interruption of business, nor any claim made by distributor's customers or any other person or entity.

This warranty will not be modified or extended. Inovonics does not authorize any person to act on its behalf to modify or extend this warranty.

This warranty will apply only to Inovonics Products. Inovonics will not be liable for any direct, incidental, or consequential damage or loss whatsoever, caused by the malfunction of Product due to products, accessories, or attachments of other manufacturers, including batteries, used in conjunction with Inovonics Products.